

# Alumaster 1:1

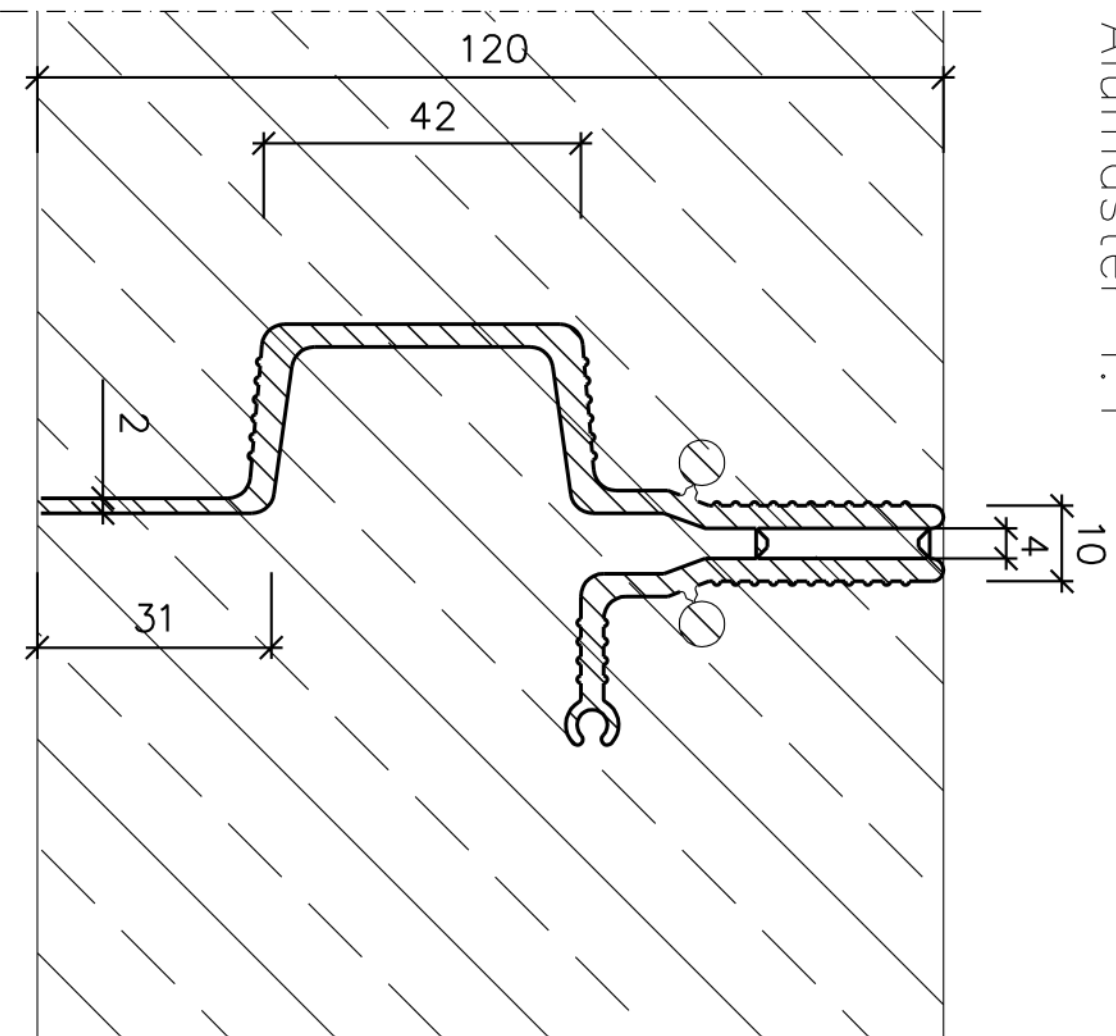

lx	66.25	cm <sup>4</sup>	Wallthickn.	3	mm	Asiakkas/Customer	Boister	B-10		
ly	14.21	cm <sup>4</sup>	Radius	0.5	mm	Radius A=3.0 B=full C=	Die DIA	∅260x170		
Wx	9.37	cm <sup>3</sup>	CD	121	mm	Asiakk.piiir./Custom.	draw nr			
Wy	4.25	cm <sup>3</sup>	Alo/Areao	778	m <sup>2</sup>	Käyttötölkkoitus/Appl	ication			
Perim.	55	(in) mm	Perim. (out)	495	mm	Tolerance EN 755-9	Päivö/Date 2005-06-23	Suhde/Scale 1:1	Torj.piiir. nr/Quotation T-20978	draw.
			g/m	2100		Pintaalaoluokka Surface Quality	5	SEOS/ALLOY EN-AW	6060 T6	Prof. nr/Section 07315